

Part #	Tooth Count	Pitch Diameter (ref)	Outer Diameter	Material
WCP-1082	34	1.700	1.800	4140 Steel
WCP-1083	36	1.800	1.900	4140 Steel
WCP-1084	38	1.900	2.000	4140 Steel
WCP-1085	40	2.000	2.100	4140 Steel
WCP-1086	42	2.100	2.200	4140 Steel
WCP-1087	44	2.200	2.300	4140 Steel
WCP-1088	46	2.300	2.400	4140 Steel
WCP-1089	48	2.400	2.500	4140 Steel
WCP-1090	50	2.500	2.600	4140 Steel
WCP-1091	52	2.600	2.700	4140 Steel
WCP-1092	54	2.700	2.800	4140 Steel
WCP-1093	56	2.800	2.900	4140 Steel
WCP-1094	58	2.900	3.000	4140 Steel
WCP-1095	60	3.000	3.100	4140 Steel
WCP-1096	62	3.100	3.200	4140 Steel
WCP-1097	64	3.200	3.300	4140 Steel
WCP-1098	66	3.300	3.400	4140 Steel
WCP-1099	68	3.400	3.500	4140 Steel
WCP-1300	70	3.500	3.600	4140 Steel
WCP-1301	72	3.600	3.700	4140 Steel
WCP-1302	74	3.700	3.800	4140 Steel
WCP-1303	76	3.800	3.900	4140 Steel
WCP-1304	78	3.900	4.000	4140 Steel
WCP-1306	80	4.000	4.100	4140 Steel
WCP-1307	82	4.100	4.200	4140 Steel
WCP-1308	84	4.200	4.300	4140 Steel

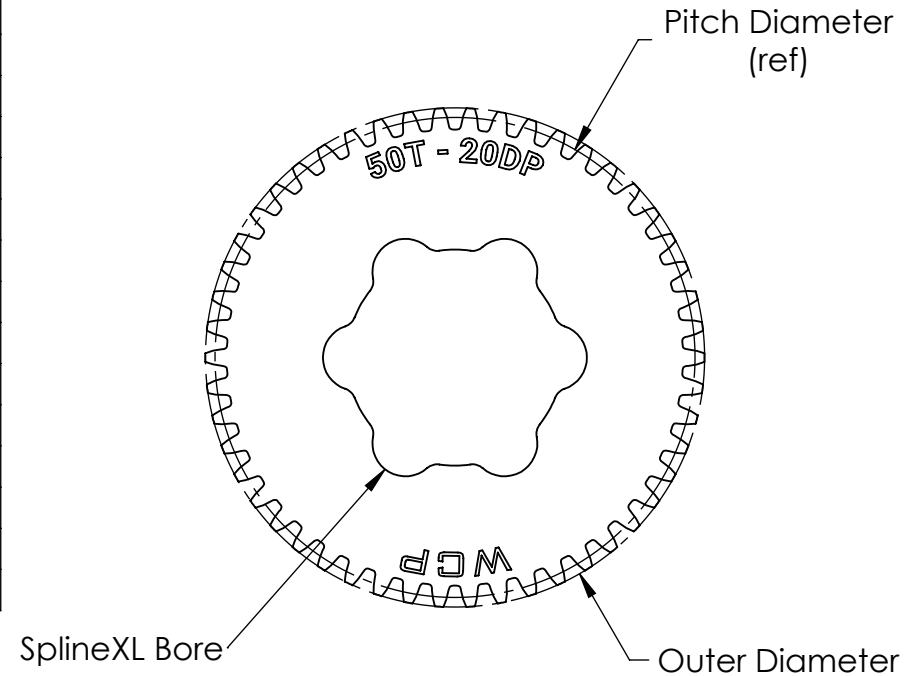
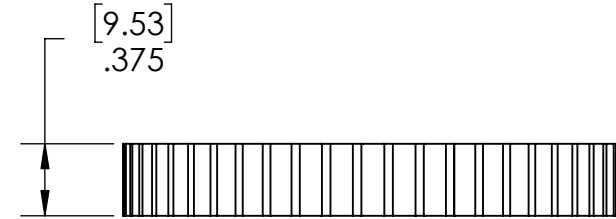

Description		Steel SplineXL Gears	
Dwg No		Web-Steel SplineXL Gears	
Project		FIRST Robotics - FRC	Sheet 1 of 1
Release		1/17/2024	ALL DIMENSIONS ARE IN INCHES [MM].