

Description	WCP-1118 - 8mm SplineXS to 1/2" Rounded Hex Adapter (1" WD)		
Dwg No	Web-SplineXS Adapters		
Project	FIRST Robotics - FRC	Sheet 1 of 1	
Release	10/11/2023	ALL DIMENSIONS ARE IN INCHES [MM].	

WWW.WCPRODUCTS.COM

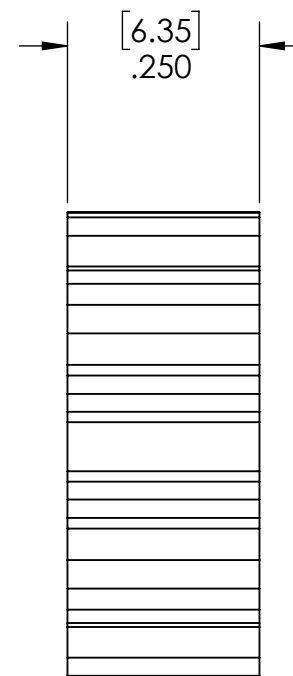
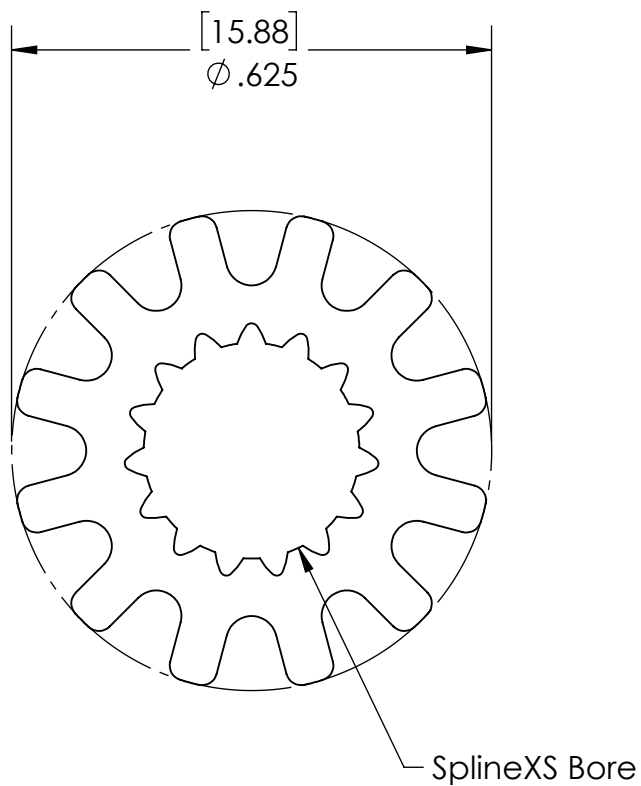

Description	WCP-1021 - 8mm SplineXS to 3D Print Adapter (1/4" WD)		
Dwg No	Web-SplineXS Adapters		
Project	FIRST Robotics - FRC	Sheet 1 of 1	
Release	10/11/2023	ALL DIMENSIONS ARE IN INCHES [MM].	

WWW.WCPRODUCTS.COM